

Double Air Valves ensure that air in the pipe will be automatically evacuated when pipeline is filled with water. Air is evacuated quickly so that water will not make back pressure and affect flow negatively. When water in pipeline is drained, air enters into pipe quickly in such a way that it will not create vacuum. It is proposed that double air valve will be used for maximum efficiency. Generally it is used in pump downstream automatic irrigation controller upstream and in elevation differentials emerged by referring water source.

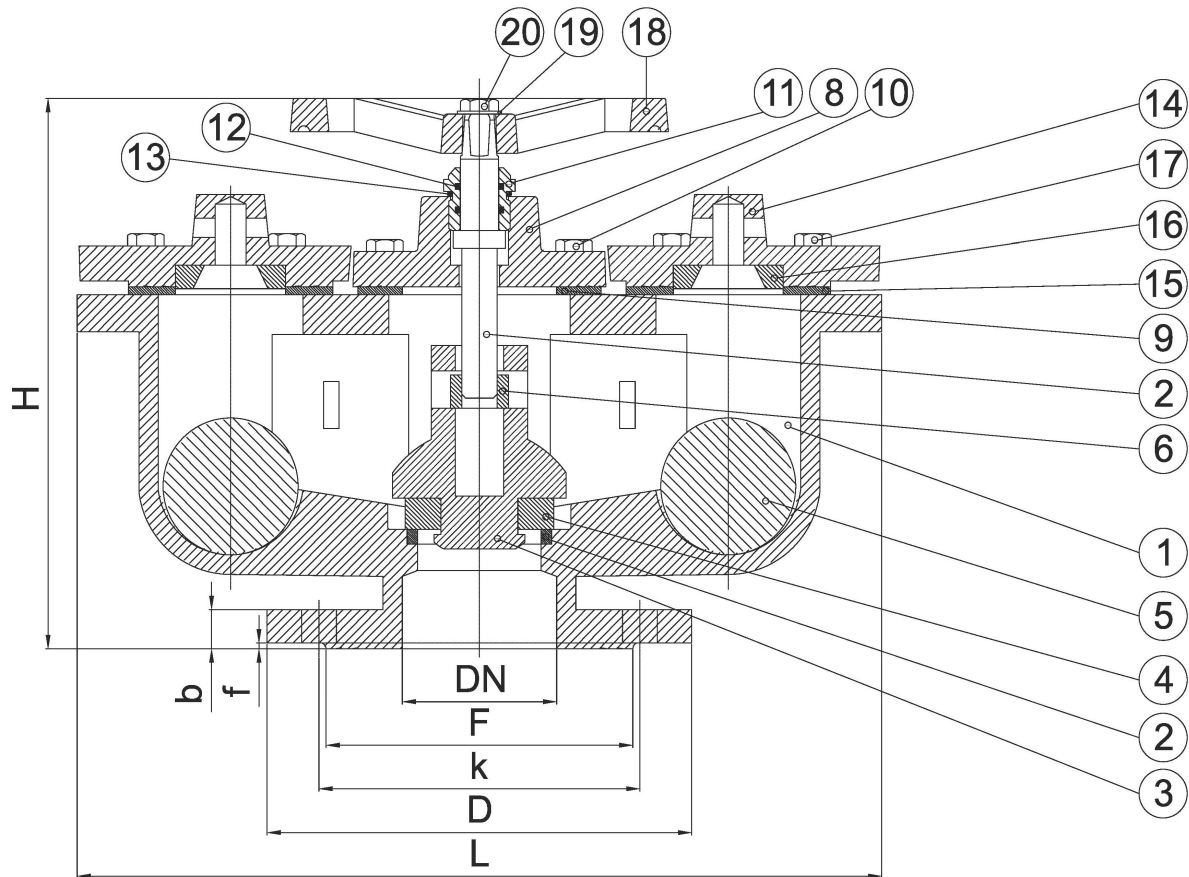

**DIMENSION TABLE FOR DOUBLE ORIFICE AIR RELEASE VALVE**

DN Nominal Diameter (mm)	D (mm)	k (mm)	F (mm)	f (mm)	b (mm)	Hole Diameter	L (mm)	H (mm)	WEIGHT (Kg)
Ø50(PN10-16)	165	125	102	3	18	Ø18x4	410	275	27
Ø68(PN10-16)	185	145	122	3	18	Ø18x4	410	275	28
Ø80(PN10-16)	200	160	138	3	20	Ø18x8	415	280	29
Ø100(PN10-16)	220	180	158	3	20	Ø18x8	415	280	31
Ø125(PN10-16)	250	210	188	3	22	Ø18x8	415	280	32
Ø150(PN10-16)	285	240	212	3	22	Ø18x8	635	400	79
Ø200(PN10)	340	295	268	3	24	Ø18x8	635	400	87
Ø200(PN16)	340	295	268	3	24	Ø18x12	635	400	87
Ø250(PN10)	395	350	320	3	26	Ø18x12	655	370	92
Ø250(PN16)	405	355	320	3	26	Ø18x12	655	370	93



NO	NAME	MATERIAL
1	Body	GG25
2	Horoscope	MS58
3	Slide	GG25
4	Slide Gasket	EPDM
5	Ball	POLYETHYLENE
6	Moving Nut	MS58
7	Shaft	X20CR13
8	Middle Cover	GG25
9	Middle Cover Gasket	EPDM
10	Middle Cover Bolt	6,8 GALVANIZED
11	Unions	GGG40
12	Unions Orings	EPDM
13	Cover O-ring	EPDM
14	Side Cover	GG25
15	Side Cover Gasket	EPDM
16	Side Cover Seal Center	EPDM
17	Side Cover Bolt	6,8 GALVANIZED
18	Handwheel	GG25
19	Handwheel Washer	Metal
20	Handwheel Bolt	6,8 GALVANIZED